

SATURDAY STAGE 1 - BAY 2

3 SHOOTING POSITIONS:

Pos 1: Left Window

Pos 2: Behind Right Counter

Pos. 3: Outside Table

10 Pistol

10 Rifle: Staged at Pos. 2 counter

2+ Shotgun: Staged at Pos. 3 Outside

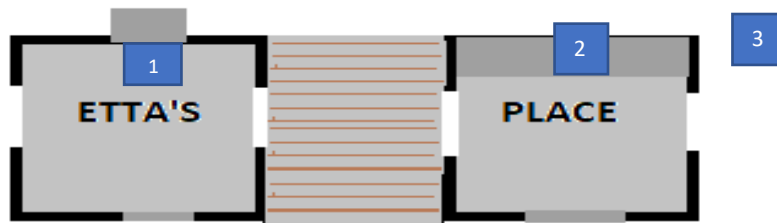
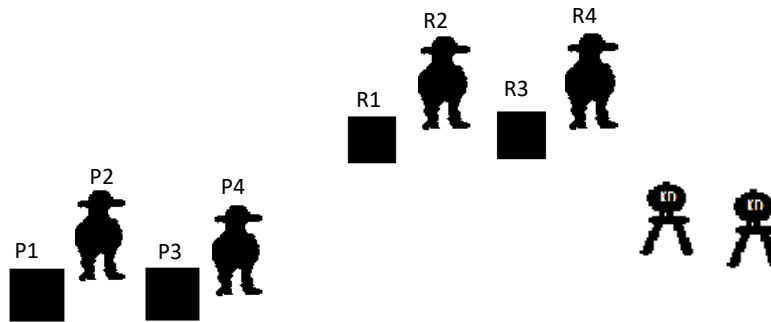

GUN ORDER: Pistol - Rifle - Shotgun

START: Position 1. **HANDS**: flat on the counter

Indicate ready by saying: " **Let's get started** "

AT THE BEEP:

PISTOL(S) @ Position 1:

Engage the closest squares and cowboys

In any pattern, Engage 2 Squares, 2 Cowboys, 2 Squares, 2 Cowboys, 2 Squares

RIFLE @ Position 2:

Engage the furthest squares and cowboys the same instructions as pistols,

SHOTGUN @ Position 3

In any order, knock down the 2 SG paddles