

SUNDAY STAGE 3 - BAY 2

3 SHOOTING POSITIONS:

Pos. 1: Left Window

Pos. 2: Center Table

Pos. 3: Right Counter

10 Pistol:

10 Rifle: Staged at center table

2+ Shotgun - Staged Pos. 3

GUN ORDER: Shooter's Choice

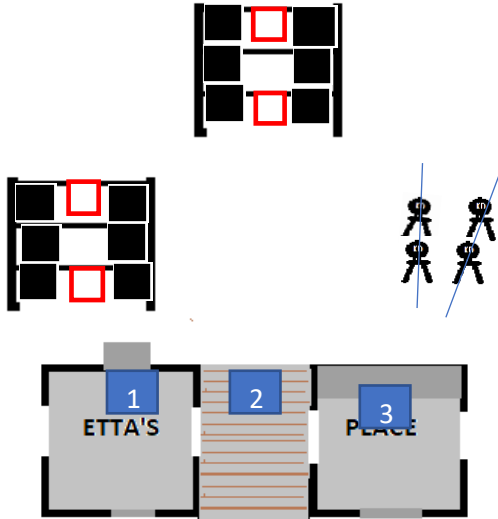

START: Any Position **HANDS:** at sides

Indicate ready: " I think I'm vertically challenged "

AT THE BEEP:

PISTOL(S) Pos. 1: Vertically sweep the LEFT squares in either direction
Then sweep the two center (white) squares in the opposite direction
Then sweep the RIGHT squares in either direction
Then sweep the two center (white) squares in the opposite direction

RIFLE @ Position 2:
Shoot the rifle targets with the same instructions as pistols

SHOTGUN @ Position 3:
Engage the four shotgun paddle targets until down.